



ANNIVERSARY 16682A



ANNIVERSARY 16682A Model number: 31ANN16682AH18

3 beds • 2 baths • 1088 sq.ft. • 16' width • 68' depth

Our home building facilities invest in continuous product and process improvements. Plans, dimensions, features, materials, specifications and availability are subject to change without notice or obligation. Renderings and floor plans are representative likenesses of our homes and may differ from the actual homes. We invite you to tour a Home Center near you and inspect the highest value in quality housing available or call (281) 354-9104 to speak with a Home Consultant. Copyright 2017, CMH. All rights reserved.

<https://www.claytonhomesofporter.com>

**CLAYTON HOMES-
PORTER**

**23557 HWY 59 NORTH
PORTER, TX 77365**

Monday - Thursday: 9am - 7pm
Friday: 9am - 6pm
Saturday: 9am - 5pm
Sunday: Closed

(281) 354-9104



ANNIVERSARY 16682A

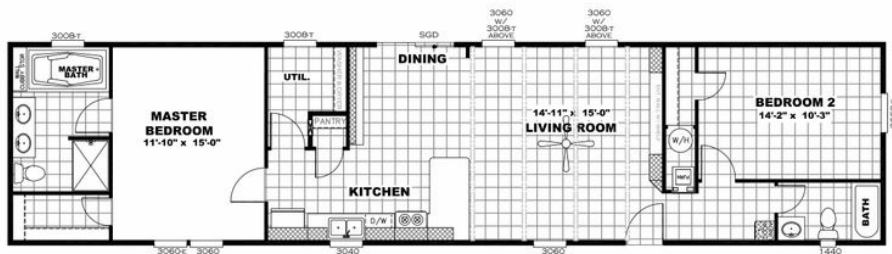

ANNIVERSARY 16682A Model number: 31ANN16682AH18

3 beds • 2 baths • 1088 sq.ft. • 16' width • 68' depth

Our home building facilities invest in continuous product and process improvements. Plans, dimensions, features, materials, specifications and availability are subject to change without notice or obligation. Renderings and floor plans are representative likenesses of our homes and may differ from the actual homes. We invite you to tour a Home Center near you and inspect the highest value in quality housing available or call (281) 354-9104 to speak with a Home Consultant. Copyright 2017, CMH. All rights reserved.

<https://www.claytonhomesofporter.com>

CLAYTON HOMES- PORTER

23557 HWY 59 NORTH
PORTER, TX 77365

Monday - Thursday: 9am - 7pm
Friday: 9am - 6pm
Saturday: 9am - 5pm
Sunday: Closed

(281) 354-9104